

Description

Especially designed for bathtubs

TÜV approved

Halogene lamp 35 watts 12 Volt (AC)

Manufactured out of solid brass; Housing nickel plated

Lamp can be changed from inside the bath tub

Glass plate is placed deeper for additional termoprotection

The changeable escutcheon is available in several surfaces (chrome, white, red, black, gold, dark-gold, dark-chrome and more)

Glass plate unbreakable an resist high temperature

With silikon-cable for high temperature, length 2,0 m



Light complete with escutcheon in chrome

Art.Nr: 620-200-35-00

Technical Details

1. Nut	brass nickel plated	ArtCode: 214-040-06-02
2. Glas plate	TSG	ArtCode: 047-001-42-04
3. Flange	brass nickel plated	ArtCode: 210-000-00-26
4. Escutcheon	brass chrome plated /	ArtCode: 220-060-05-00
5. Body	brass nickel plated	ArtCode: 205-100-00-37
6. Cable gland	brass nickel plated	ArtCode: 031-035-16-16
7. Screw	Steel galvanized	ArtCode: 012-022-03-06
8. Cable	2 x 1,5mm ²	ArtCode: 031-130-15-20
9. Seal	NBR70	ArtCode: 010-003-70-20
10. Silicone seal		ArtCode: 011-040-49-15
11. Silicone seal		ArtCode: 011-040-60-20
12. Lamp	35W	ArtCode: 045-001-35-36
13. Lable		ArtCode: 820-000-01-03
14. Ceramic plug		ArtCode: 031-050-00-01

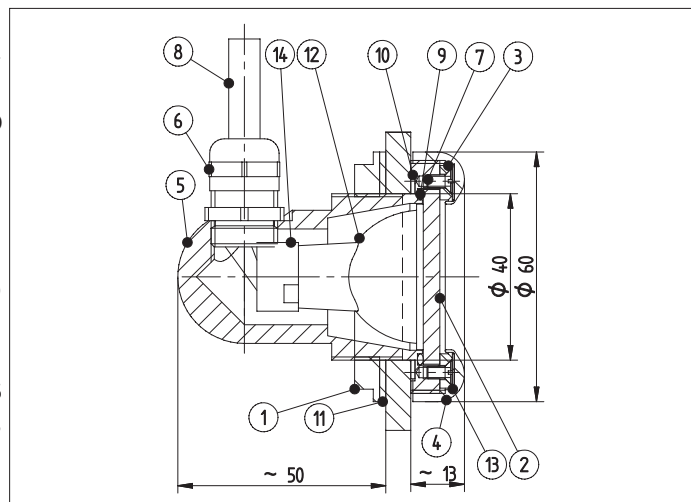

Accessories

Safety transformer

Sitra 50 VA, 230 V 12V IP65
Art.Nr. 760-050-01-02

Sitra 105 VA, 230V - 12V, IP65
Art.Nr. 760-050-01-03



Color plates

Color plates for UWS-H, red, blue, green, yellow

Art.Nr. 980-001-08-00

